

# \$850,000 - 500 Parkins Avenue, Rural Lac Ste. Anne County

MLS® #E4382358

**\$850,000**

0 Bedroom, 0.00 Bathroom,  
Land Commercial on 0.00 Acres

None, Rural Lac Ste. Anne County, AB

Discover 44+/- acres of boundless outdoor opportunities nestled in the Summer Village of Ross Haven! Formerly a golf course. Embrace lakeside living as you envision your dream home, just steps away from the shores of Lac Ste Anne. Offering year-round recreational outdoor activities conveniently situated, just 30 minutes to Stony Plain/Spruce Grove and 45 minutes to Edmonton. Experience the perfect blend of tranquility and accessibility on your own piece of lakeside paradise. Water wells on property.

## Essential Information

MLS® #	E4382358
Price	\$850,000
Bathrooms	0.00
Acres	0.00
Type	Land Commercial
Status	Active

## Community Information

Address	500 Parkins Avenue
Area	Rural Lac Ste. Anne County
Subdivision	None
City	Rural Lac Ste. Anne County

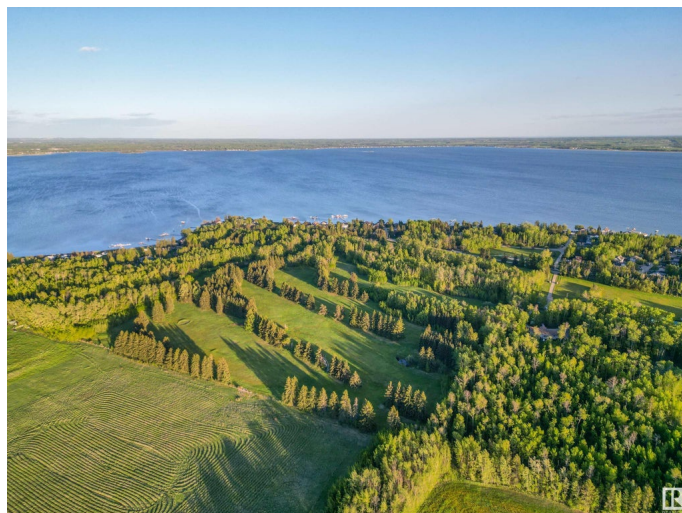
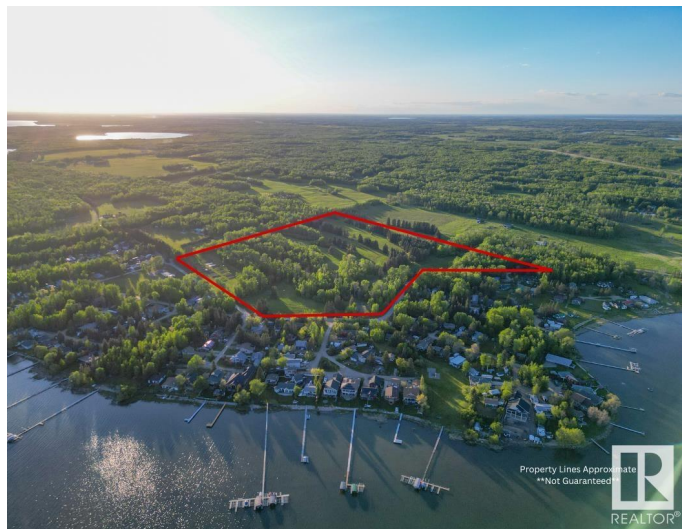

County	ALBERTA
Province	AB
Postal Code	T0E 1A0

### **Additional Information**

Date Listed	April 16th, 2024
Days on Market	417
Zoning	Zone 70

DATA IS DEEMED RELIABLE BUT IS NOT GUARANTEED ACCURATE BY THE REALTORS® ASSOCIATION OF EDMONTON. COPYRIGHT 2025 BY THE REALTORS® ASSOCIATION OF EDMONTON. ALL RIGHTS RESERVED. Trademarks are owned or controlled by the Canadian Real Estate Association (CREA) and identify real estate professionals who are members of CREA (REALTOR®, REALTORS®) and/or the quality of services they provide (MLS®, Multiple Listing Service®)

Listing information last updated on June 7th, 2025 at 5:17pm MDT