

\$40,000 - 4611 Lily Court, Cold Lake

MLS® #E4410515

\$40,000

0 Bedroom, 0.00 Bathroom,
Single Family on 0.00 Acres

Cold Lake South, Cold Lake, AB

This 799-square-meter residential lot with R1A zoning offers an excellent opportunity for builders at a great price! Located near the 4 Wing Base and Cold Lake city centre, it's close to schools, shopping, and golfing, making it an ideal spot for future homeowners. Perfect for building your custom home in a desirable location with easy access to all essentials. Donâ€™t miss this fantastic opportunity in a prime area!

Essential Information

| | |
|-----------|-----------------|
| MLS® # | E4410515 |
| Price | \$40,000 |
| Bathrooms | 0.00 |
| Acres | 0.00 |
| Type | Single Family |
| Sub-Type | Vacant Lot/Land |
| Status | Active |

Community Information

| | |
|-------------|-----------------|
| Address | 4611 Lily Court |
| Area | Cold Lake |
| Subdivision | Cold Lake South |
| City | Cold Lake |
| County | ALBERTA |
| Province | AB |
| Postal Code | T9M 0J4 |

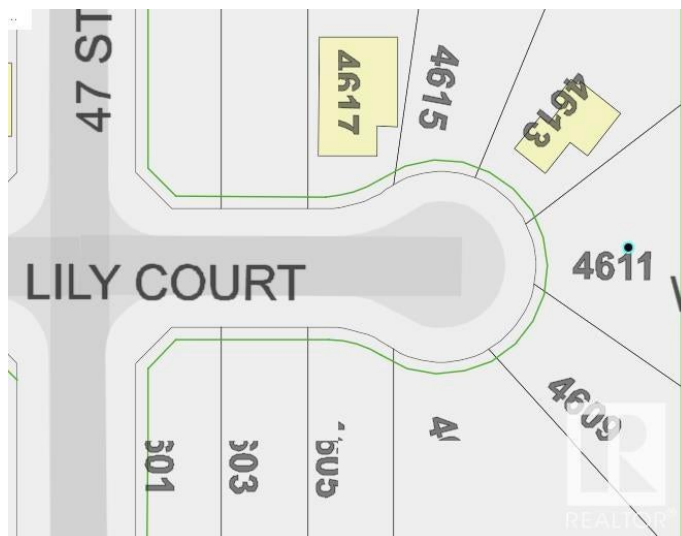

Exterior

Exterior Features Cul-De-Sac, Flat Site, Golf Nearby, Playground Nearby, Schools, Shopping Nearby

Additional Information

Date Listed October 15th, 2024
Days on Market 210
Zoning Zone 60

DATA IS DEEMED RELIABLE BUT IS NOT GUARANTEED ACCURATE BY THE REALTORS® ASSOCIATION OF EDMONTON. COPYRIGHT 2025 BY THE REALTORS® ASSOCIATION OF EDMONTON. ALL RIGHTS RESERVED.Trademarks are owned or controlled by the Canadian Real Estate Association (CREA) and identify real estate professionals who are members of CREA (REALTOR®, REALTORS®) and/or the quality of services they provide (MLS®, Multiple Listing Service®)
Listing information last updated on May 13th, 2025 at 12:02am MDT