

## \$329,800 - 58 Ave, Rural Leduc County

MLS® #E4436794

**\$329,800**

0 Bedroom, 0.00 Bathroom,

Rural on 0.10 Acres

Royal Oaks\_LEDU, Rural Leduc County, AB

38 pocket-48 ft wide NORTH facing WALK OUT lot in the most sought-after community of Royal Oak surrounded by beautiful million dollar homes, ready for your new Custom dream home. Municipal water & sewer services in this area. Excellent location close to Edmonton, Nisku, Beaumont and Leduc. Accessible to QE2 Highway, Airport, Premium Outlet Mall and 41st Ave sw.



### Essential Information

MLS® #	E4436794
Price	\$329,800
Bathrooms	0.00
Acres	0.10
Type	Rural
Sub-Type	Vacant Lot/Land
Status	Active

### Community Information

Address	58 Ave
Area	Rural Leduc County
Subdivision	Royal Oaks_LEDU
City	Rural Leduc County
County	ALBERTA
Province	AB
Postal Code	T4X 0X9

Exterior

Exterior Features    Airport Nearby, Back Lane, G

Additional Information

Date Listed                May 15th, 2025  
Days on Market        31  
Zoning                      Zone 80

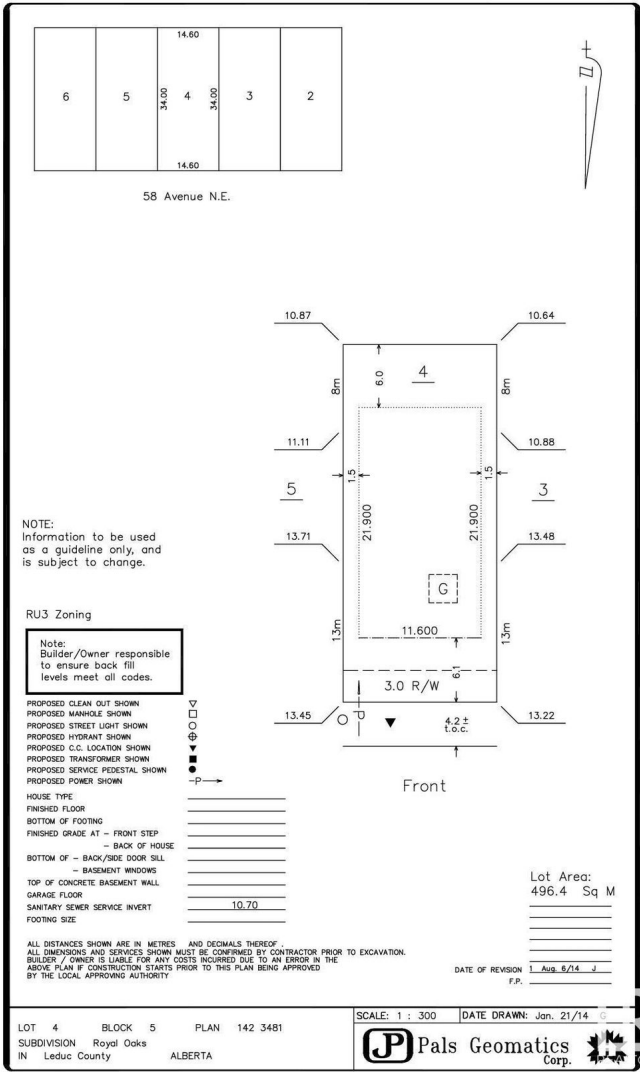

DATA IS DEEMED RELIABLE BUT IS NOT GUARANTEED ACCURATE BY THE REALTORS® ASSOCIATION OF EDMONTON. COPYRIGHT 2025 BY THE REALTORS® ASSOCIATION OF EDMONTON. ALL RIGHTS RESERVED. Trademarks are owned or controlled by the Canadian Real Estate Association (CREA) and identify real estate professionals who are members of CREA (REALTOR®, REALTORS®) and/or the quality of services they provide (MLS®, Multiple Listing Service®)

Listing information last updated on June 15th, 2025 at 6:17pm MDT