

\$21,000 - 836, 11013 Highway 28, Rural St. Paul County

MLS® #E4440037

\$21,000

0 Bedroom, 0.00 Bathroom,

Rural on 0.49 Acres

Upper Mann Lake, Rural St. Paul County, AB

This half acre property is situated within a serene community on Kaehn Drive, approximately 25 minutes from the town of St. Paul and about 2 hours from Edmonton, making it a convenient retreat from urban life. The area boasts numerous nearby lakes suitable for boating and swimming, the Mann Lakes Golf Course for leisurely rounds, and access to the Iron Horse Trail, which offers year round opportunities for quadding, snowmobiling and more! Low property taxes, quiet location, power and gas close to bring in, flat land for development makes this spot a perfect location to make your own.

Essential Information

MLS® #	E4440037
Price	\$21,000
Bathrooms	0.00
Acres	0.49
Type	Rural
Sub-Type	Vacant Lot/Land
Status	Active

Community Information

Address	836, 11013 Highway 28
Area	Rural St. Paul County
Subdivision	Upper Mann Lake

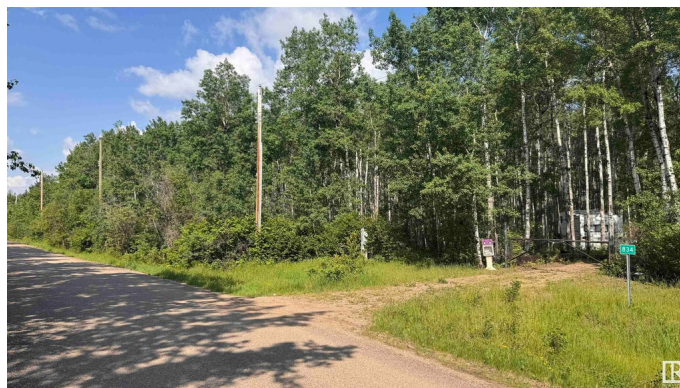
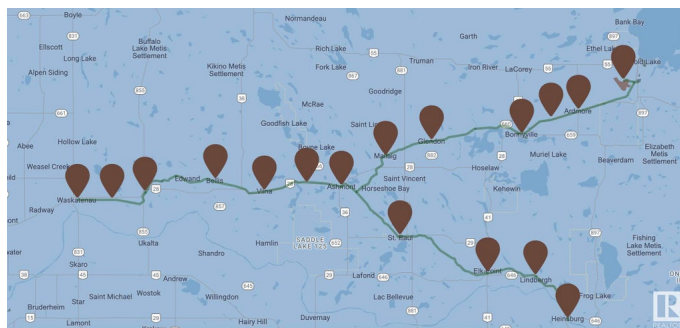
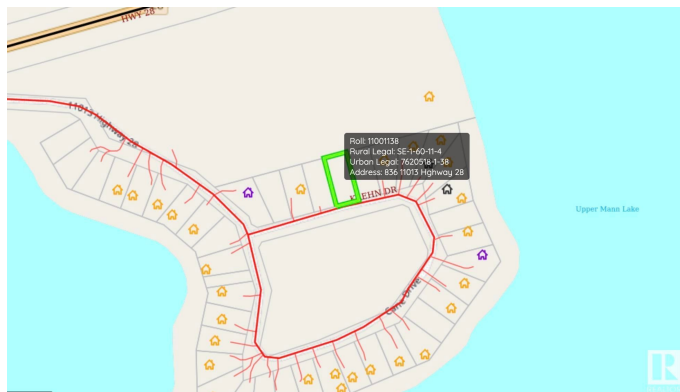

City	Rural St. Paul County
County	ALBERTA
Province	AB
Postal Code	T0A 0C0

Exterior

Exterior Features	Flat Site, Golf Nearby, Not Fenced, Schools, Shopping Nearby, Treed Lot
-------------------	---

Additional Information

Date Listed	June 3rd, 2025
Days on Market	4
Zoning	Zone 60

DATA IS DEEMED RELIABLE BUT IS NOT GUARANTEED ACCURATE BY THE REALTORS® ASSOCIATION OF EDMONTON. COPYRIGHT 2025 BY THE REALTORS® ASSOCIATION OF EDMONTON. ALL RIGHTS RESERVED. Trademarks are owned or controlled by the Canadian Real Estate Association (CREA) and identify real estate professionals who are members of CREA (REALTOR®, REALTORS®) and/or the quality of services they provide (MLS®, Multiple Listing Service®)

Listing information last updated on June 7th, 2025 at 12:47pm MDT