

\$50,000 - 5595 Nakamun, Rural Lac Ste. Anne County

MLS® #E4440813

\$50,000

0 Bedroom, 0.00 Bathroom,
Rural on 0.65 Acres

Nakamun Park, Rural Lac Ste. Anne County,
AB

Looking for the perfect summer escape? This prime corner lot is just steps from lake access—ideal for building your dream cabin and enjoying everything lake life has to offer. With power and gas at the property line, you're ready to start creating your retreat. Please note: RVs are not permitted, and all cabins must be a minimum of 800 sq ft, ensuring a well-maintained, cohesive community feel. Enjoy nearby picnic areas, parks, and a boat launch, perfect for boating, fishing, and relaxing with friends and family. Whether you're planning a weekend getaway or a seasonal sanctuary, this lot offers unmatched value, flexibility, and location—just 50 minutes from Edmonton, 45 from Spruce Grove, and 20 to Onoway. Affordable, accessible, and packed with potential—don't miss your chance to invest in the lake lifestyle you've been dreaming of!

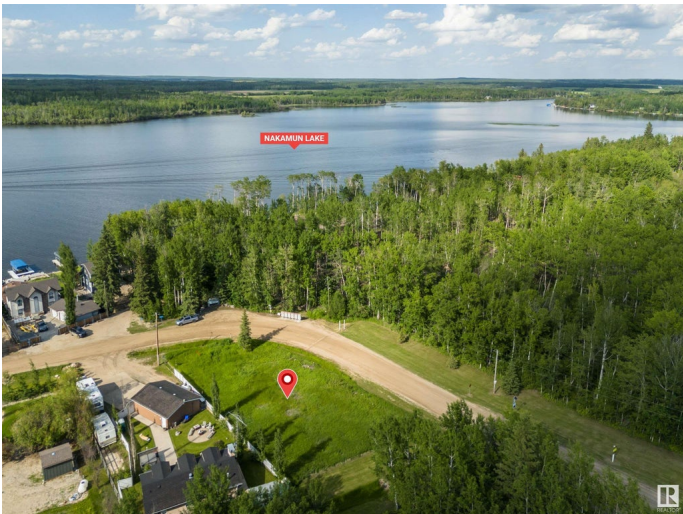
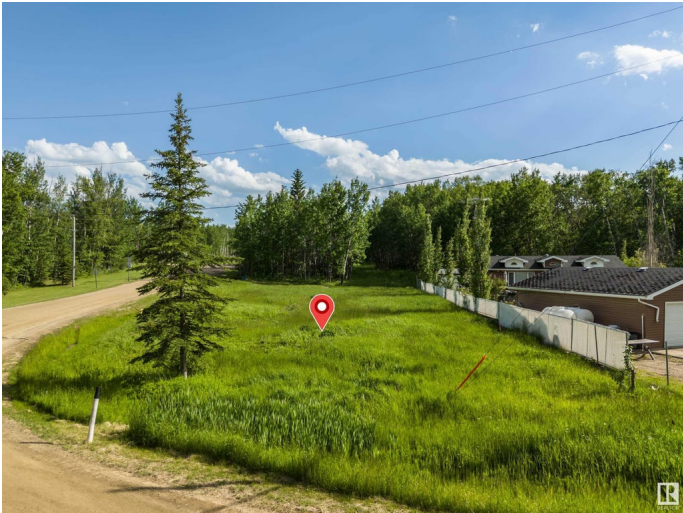
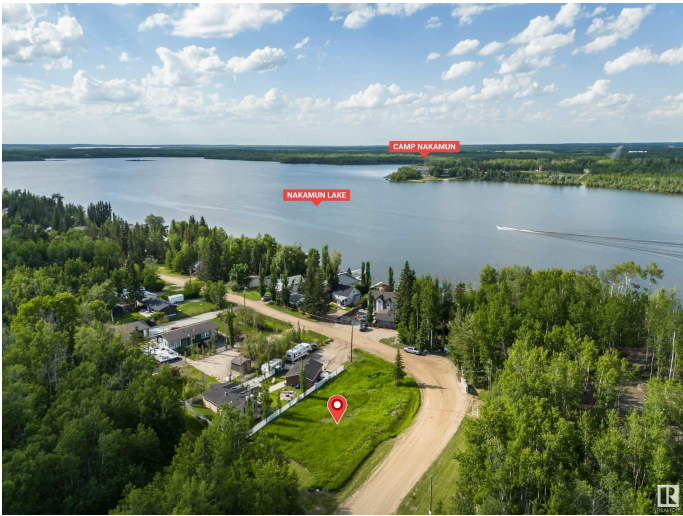

Essential Information

| | |
|-----------|----------|
| MLS® # | E4440813 |
| Price | \$50,000 |
| Bathrooms | 0.00 |
| Acres | 0.65 |
| Type | Rural |

| | |
|----------|-----------------|
| Sub-Type | Vacant Lot/Land |
| Status | Active |

Community Information

| | |
|-------------|----------------------------|
| Address | 5595 Nakamun |
| Area | Rural Lac Ste. Anne County |
| Subdivision | Nakamun Park |
| City | Rural Lac Ste. Anne County |
| County | ALBERTA |
| Province | AB |
| Postal Code | T0E 1V0 |

Exterior

| | |
|-------------------|--|
| Exterior Features | Beach Access, Boating, Corner Lot, Lake Access Property, Lake View, Playground Nearby, See Remarks |
|-------------------|--|

Additional Information

| | |
|----------------|----------------|
| Date Listed | June 6th, 2025 |
| Days on Market | 52 |
| Zoning | Zone 73 |

DATA IS DEEMED RELIABLE BUT IS NOT GUARANTEED ACCURATE BY THE REALTORS® ASSOCIATION OF EDMONTON. COPYRIGHT 2025 BY THE REALTORS® ASSOCIATION OF EDMONTON. ALL RIGHTS RESERVED. Trademarks are owned or controlled by the Canadian Real Estate Association (CREA) and identify real estate professionals who are members of CREA (REALTOR®, REALTORS®) and/or the quality of services they provide (MLS®, Multiple Listing Service®)

Listing information last updated on July 28th, 2025 at 4:17am MDT